

(SEE FIGURE 2)

FIGURE 1
PRINCIPAL DIMENSIONS & DATUMS

JEDEC SOLID STATE PRODUCT OUTLINES	THIS REGISTERED OUTLINE HAS BEEN PREPARED BY THE JEDEC JC-11 COMMITTEE AND REFLECTS A PRODUCT WITH ANTICIPATED WIDE USAGE IN THE ELECTRONICS INDUSTRY; CHANGES ARE LIKELY TO OCCUR.				
TITLE: THIN SMALL OUTLINE PACKAGE FAMILY, TYPE I	R-PDSO-G/TSOPII	ISSUE: D	DATE: JULY 2000	MO-142	PAGE: 1 OF 5

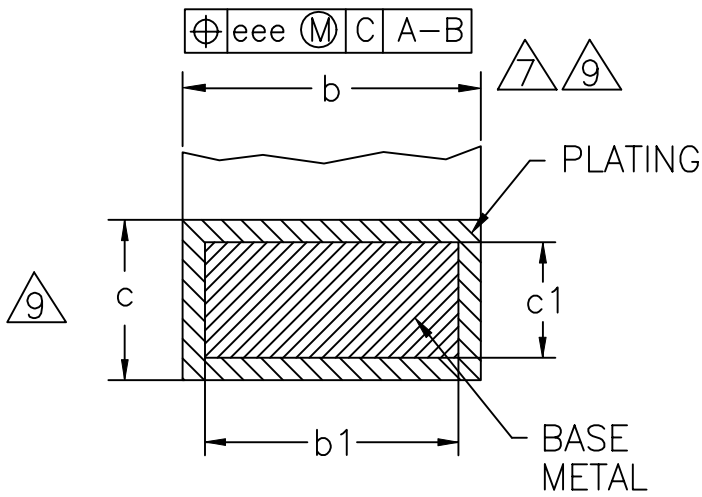

FIGURE 2 SECTION A-A
TERMINAL DETAILS

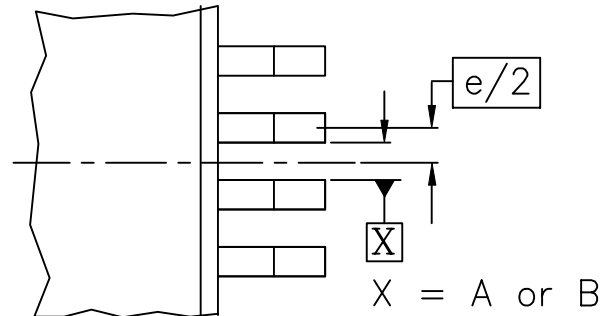

FIGURE 3

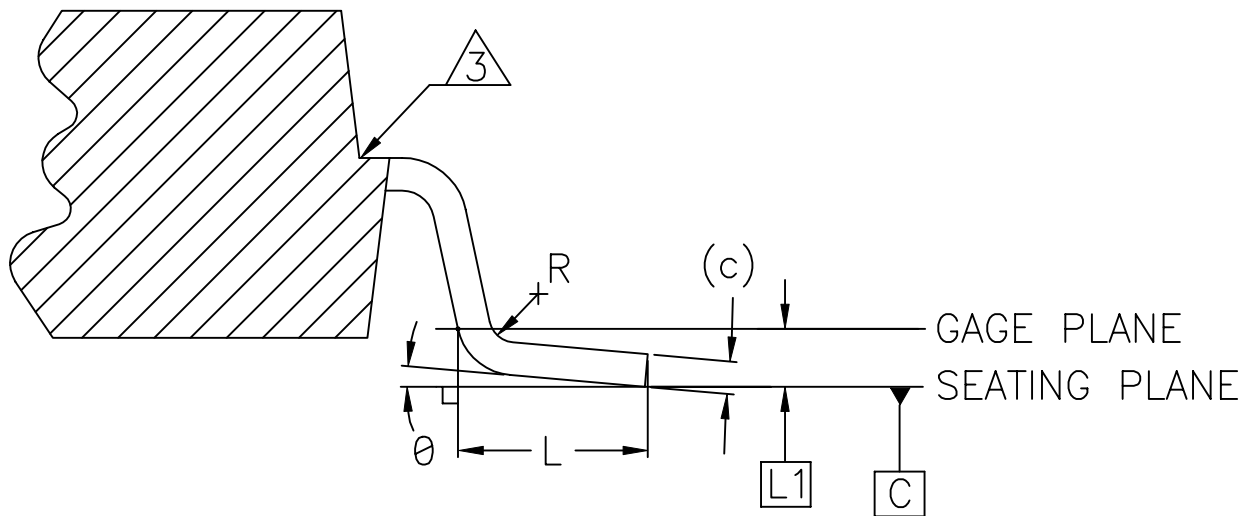

FIGURE 4 SECTION B-B

SYMBOL	COMMON DIMENSIONS MILLIMETERS			NOTES
	MIN	NOM	MAX	
A	—	—	1.20	
A1	0.05	—	0.15	
A2	0.95	1.00	1.05	
b	0.17	0.22	0.27	7, 9
b1	0.17	0.20	0.23	9
c	0.10	—	0.21	9
c1	0.10	—	0.16	9
e	0.50 BASIC			
L	0.50	0.60	0.70	
L1	0.25 BASIC			
R	0.08	—	0.35	
θ	0	5°	8°	
GEOMETRIC TOLERANCES				
aaa	0.25			
bbb	0.10			5
ccc	0.10			5
ddd	0.10			
eee	0.08			
NOTES	1,2			
ISSUE	C			
REF	11-516/1-583E			

VARIATIONS (ALL DIMENSIONS IN mm)

SYMBOL	AA	AB	AC	AD		BA	BB	BC	BD	NOTES
	BASIC	BASIC	BASIC	BASIC		BASIC	BASIC	BASIC	BASIC	
D	14.00	16.00	18.00	20.00		14.00	16.00	18.00	20.00	4
D1	12.40	14.40	16.40	18.40		12.40	14.40	16.40	18.40	5
E	6.00	6.00	6.00	6.00		8.00	8.00	8.00	8.00	5
N	24	24	24	24		32	32	32	32	
SYMBOL	CA	CB	CC	CD		DA	DB	DC	DD	NOTES
	BASIC	BASIC	BASIC	BASIC		BASIC	BASIC	BASIC	BASIC	
D	14.00	16.00	18.00	20.00		14.00	16.00	18.00	20.00	4
D1	12.40	14.40	16.40	18.40		12.40	14.40	16.40	18.40	5
E	10.00	10.00	10.00	10.00		12.00	12.00	12.00	12.00	5
N	40	40	40	40		48	48	48	48	
NOTES					1,2					
ISSUE					A					
REF					11-305					
SYMBOL	EA	EB	EC							NOTES
	BASIC	BASIC	BASIC							
D	16.00	18.00	20.00							4
D1	14.40	16.40	18.40							5
E	14.00	14.00	14.00							5
N	56	56	56							
NOTES					1,2					
ISSUE					B					
REF					11-362					

NOTES:

1. ALL DIMENSIONING AND TOLERANCING CONFORMS TO ASME Y14.5M-1994.

2. ALL DIMENSIONS ARE IN MILLIMETERS.

△3 THIS IS AN OPTIONAL FEATURE.

△4 TO BE DETERMINED AT SEATING PLANE C.

△5 PROFILE TOLERANCE ZONES FOR D1 AND E DO NOT INCLUDE MOLD PROTRUSION. ALLOWABLE MOLD PROTRUSION ON E IS 0.15 mm PER SIDE AND ON D1 IS 0.25 mm PER SIDE.

△6 PIN 1 IDENTIFIER MUST BE CONTAINED WITHIN THE ZONE INDICATED. MAX. WIDTH = 1.5 mm; MAX LENGTH = 1.5 mm. DETAILS OF THE PIN 1 IDENTIFIER ARE AT USER'S OPTION.

△7 DIMENSION b DOES NOT INCLUDE DAMBAR PROTRUSION. ALLOWABLE DAMBAR PROTRUSION SHALL BE 0.08 mm TOTAL IN EXCESS OF THE b DIMENSION AT MAXIMUM MATERIAL CONDITION. DAMBAR CANNOT BE LOCATED ON THE LOWER RADIUS OR THE FOOT. MINIMUM SPACE BETWEEN PROTRUSION AND AN ADJACENT LEAD TO BE 0.07 mm.

△8 EXACT SHAPE OF EACH CORNER IS OPTIONAL.

△9 THESE DIMENSIONS APPLY TO THE FLAT SECTION OF THE LEAD BETWEEN 0.10 mm AND 0.25 mm FROM THE LEAD TIP.